

# CENTENNIAL HALL

3929 GRAND AVENUE • DALLAS, TX



Centennial Hall is the largest exhibit hall at Fair Park. The Centennial Building was originally constructed in 1905 as the first steel and masonry exhibition building on the fairgrounds. Dahl's renovation in 1936 incorporated a pair of murals by Carlo Ciampaglia under each portico, monumental sculptures by Pierre Bourdelle and Raoul Josset in front of each portico and bas reliefs by Bourdelle. Guests will enjoy the Esplanade Fountain and convenient parking next to the building and access from Gates 2 & 3. Upgrades in 1999 included a new floor.

90,000 sq. ft./606' x 165'

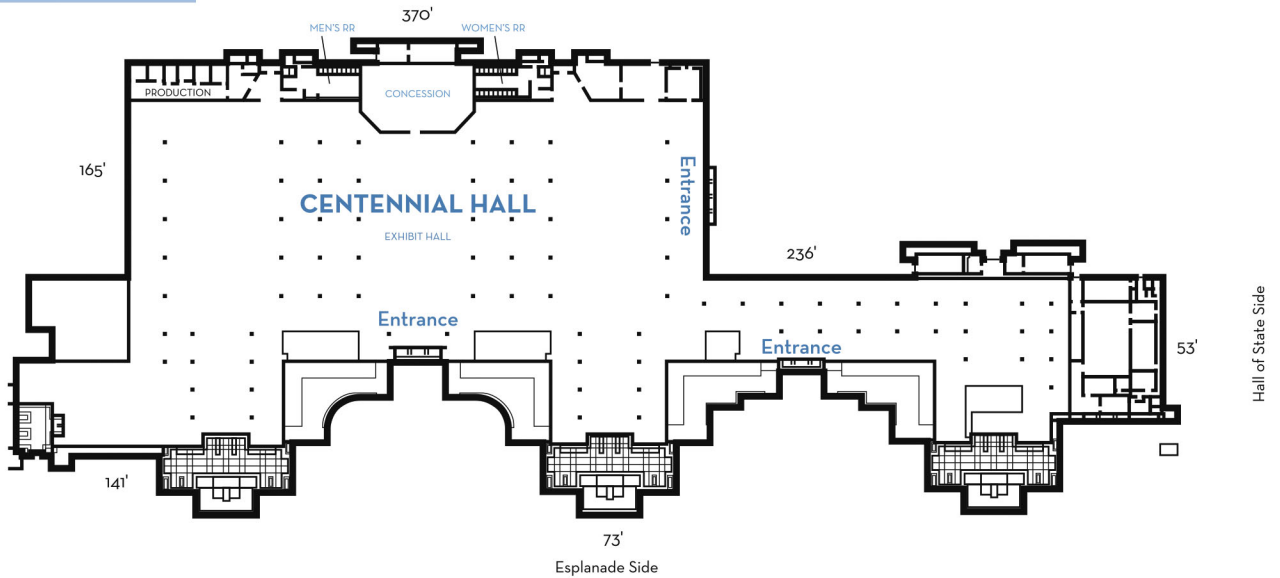

## USES

Exhibitions, Fairs, Performances, Parties, Galas, Markets, Car Shows, Trade Shows, Festivals, Indoor Sports, Conventions

## AMENITIES

Large Hall with Columns, Centennial Monuments, Art Deco Exterior, Hangar Interior, Natural Lighting

## SPACE/CEILING

90,000 sq. ft.  
18'4" to Beam; 32'6" to Ceiling

## BUILDING SPECIFICATIONS

Theater Style	N/A
Bathroom Stalls	24M, 20W

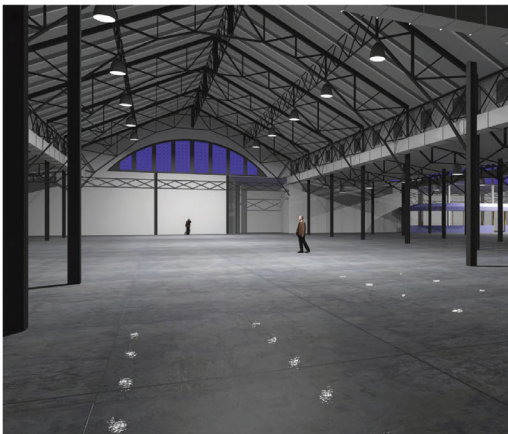

Centennial Hall Facade



For more information please contact [fairparkevents@dallascityhall.com](mailto:fairparkevents@dallascityhall.com)